

THEORY TEST DAY INSTRUCTIONS

- ❑ The test begins at 1:30 p.m.
- ❑ Students will please bring two pencils, erasers, and a small pencil sharpener, if desired.
 - ⇒ There are no pencil sharpeners in the room.
 - ⇒ Paper keyboards and scratch paper will be provided.
 - ⇒ Clipboards are allowed where designated. Nothing else is allowed.
- ❑ No one is allowed in the test room except the students being tested, the proctor, and the designated monitors.
- ❑ Everyone not involved in the test taking will be required to wait in Parent Waiting Area, which will be in Fellowship Hall in the Resler Hall building. Monitors will bring the 1st, 2nd, and 3rd graders from the first floor to Fellowship Hall to meet their parents. All other grades will be sent to Parent Waiting Area to meet their parents unaccompanied.
 - ⇒ Parents, please do not congest the halls, nor try to pick up your child at the test room. Please help us maintain the best testing environment in which to take the exam.
- ❑ No one will be accepted for testing after 1:45 p.m.
All test results should be completed and turned in no later than 3:30 p.m.
- ❑ If a student is taking the theory test at a level other than his school grade level, he reports to the room of the test level he is taking, not his school grade level.
- ❑ Estimated times for completion of the test:

<u>1st, 2nd, 3rd</u>	1 hour	<u>7th, 8th, 9th</u>	2 hours
<u>4th, 5th, 6th</u>	1½ hours	<u>10th, 11th, 12th</u>	2 hours
- ❑ Parents are advised to pay close to attention to the estimated times of completion. Ninety percent of the children will be finished by 3:00 p.m. Most of those in high school taking the advanced tests will be finished by 3:30 p.m.
 - ⇒ Please pick up your children on time. We cannot be responsible for testing 300 students and also providing care for them after the test.
- ❑ There is no telephone available at the church.
 - ⇒ We have a mobile phone for emergencies only.

THANK YOU VERY MUCH FOR YOUR COOPERATION

El Paso Music Teachers Association State Theory Exam

February 6, 2010
Saturday 1:30 - 3:30 PM
Trinity Methodist Church
801 N. Mesa St.

Please bring this map with you to the theory test. For security reasons, this is your ticket to the test. Teachers will collect the maps before the test.

Grades 4 through 12 need to bring clipboards.

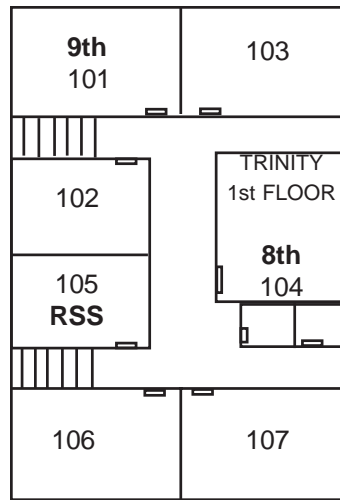

OREGON STREET

RESLER HALL

- 112 - Kindergarten
- 102 - Grade 1
- 111 - Grade 2
- 113 - Grade 3
- Chapel - Grade 4
- Parlor - Grade 5
- Sanctuary - Grade 6
- Choir Room - Grade 7
- 201 - Grade 11
- 200 - Grade 12

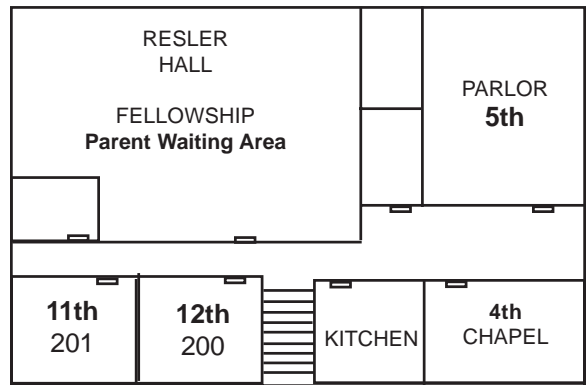
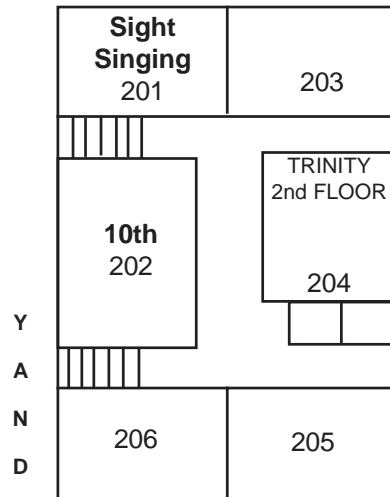

Y
A
N
D
E
L
L

M
O
N
T
A
N
A

TRINITY HALL

- 104 - Grade 8
- 101 - Grade 9
- 202 - Grade 10
- 201 - Sight Singing
- 105 - Rhythmic Sight Reading

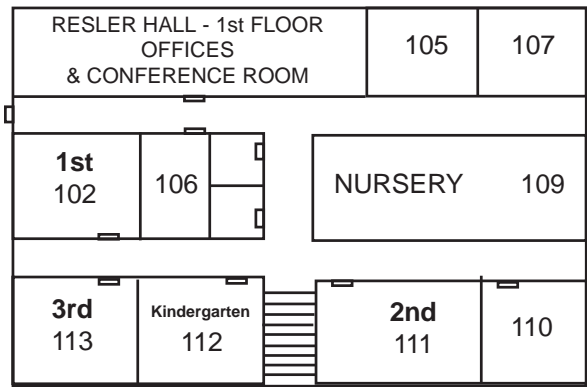
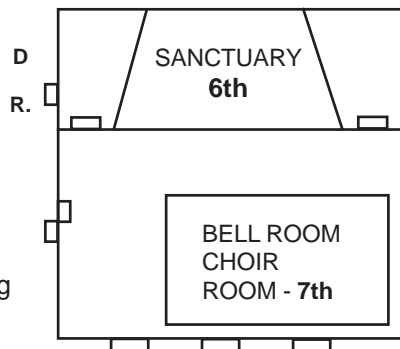

MESA STREET

D
R.

A
V
E.

